

- 1、FUNCTION: ON-ON
- 2、RATING: UL: 8(6)A 125/250VAC 6E3
CQC: 8A/128A 250VAC
ENEC VDE: 12A 125VAC 6(4)A 250VAC T105

- 3、OPERATION FORCE: 650±350g.f
- 4、CONTACT RESISTANCE: ≤ 50 mΩ
- 5、INSULATION RESISTANCE: ≥ 100 MΩ
- 6、DIELECTRIC WITHSTAND:

TERMINAL TO BUTTON 3000VAC/5mA/1MIN/TUE
TERMINAL TO TERMINAL 1500VAC/5mA/1MIN/TUE

7、CIRCUIT DIAGRAM:

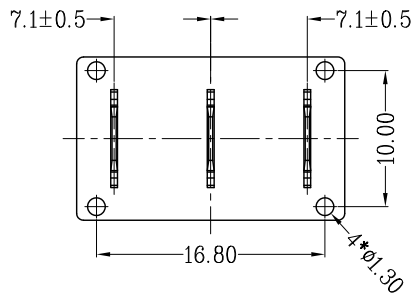
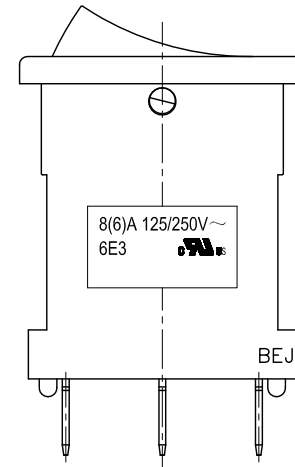
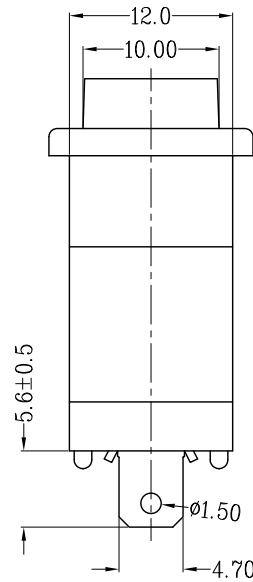
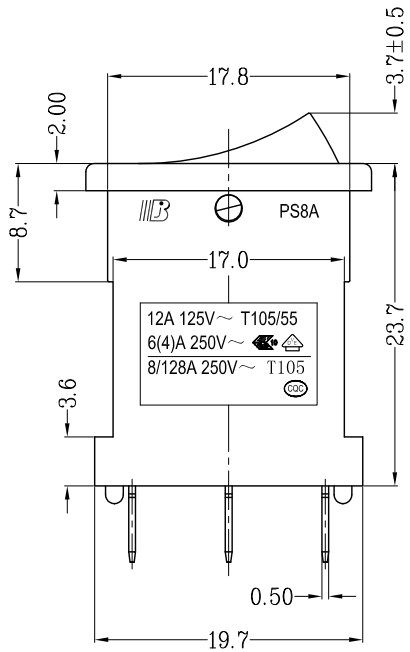
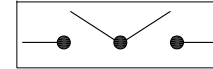

8、SUGGESTED PANEL HOLE SIZE:

